



Ardencote



Conference & Events



Ardencote is a proudly independent countryside Business destination with a deep commitment to sustainability and enhancing the environment, appealing to the discerning Business traveller who holds excellent customer service and exceptional facilities paramount.





WE MEAN BUSINESS

Ardencote is a picturesque four star hotel situated a few miles from Junction 15 of the M40 in the Warwickshire countryside. It is a 30 minute drive from Birmingham International Airport and a convenient 10 minute taxi ride to Warwick Parkway offering continuous train links to London, Birmingham and beyond.

Ardencote offers an unrivalled environment to host conferences, meetings and events of up to 175 guests in 10 versatile indoor spaces to choose from. It also boasts 110 newly refurbished onsite hotel Bedrooms, multiple outdoor event spaces, an 18 hole Golf Course, a 5 Bubble Spa rated Destination Spa, and a multifaceted Leisure Club with tennis courts.

Ardencote offers in excess of 200 free car parking spaces with Electric Vehicle charging points.



MEETING YOUR NEEDS

Ardencote's 10 meeting spaces are located in the 19th century Manor House, the Lodge and the Lakeside, a purpose-built conference venue with bedrooms for delegates if required. All meeting rooms have natural daylight and complimentary super fast Wi-Fi internet access.



LAKESIDE SUITES

Arden Suite
Claverton Suite
Cedar Room
Blue Room
Green Room

MANOR HOUSE SUITES

Palms Conservatory
Henley Suite
The Oak Room
The Library

THE LODGE

Independent Events Space
Lakeside Venue
Private Terrace
Private Bar
Private Lounge
Private Car Park





MANOR HOUSE



The Palms Conservatory

The Palms Conservatory

The Palms Conservatory boasts its own private outdoor seating area, ideal for drinks receptions. A stylish conservatory seating up to 120 guests for a banquet, complete with its own private bar, dance floor and staging area. In conjunction with the Henley Suite the Palms Conservatory can comfortably accommodate 160 guests.

Oak Room

The Oak Room bursting with natural daylight, is a beautiful suite with high ceilings, oak panelling, ornate chandeliers and a working fireplace, situated within the 19th century Manor House, the Oak Room can be used for both meetings and private dining.

Henley Suite

The Henley Suite situated in the heart of the Manor House is an elegant suite for up to 50 delegates. Filled with natural daylight with blackout facility, air conditioning and a 65" LCD with built in Apple TV, accessible through analogue and wireless connections.

Library

The Library is an elegantly furnished suite with original features, the ideal venue for small meetings and intimate private dining.

LAKESIDE

Claverdon Suite

The Claverdon Suite is an elegant suite suitable for up to 100 delegates with stunning views of the Ardencote's manicured grounds, providing natural daylight, air conditioning and a 65" LCD with built in Apple TV, accessible through analogue and wireless connections. The Claverdon divides into 2 rooms, via a fully partitioned sound proofed wall.

Claverdon I & II are is suitable for 50 and 40 delegates respectively, providing natural daylight, air conditioning and a 65" LCD with built in Apple TV, accessible through analogue and wireless connections.

Cedar Room

The Cedar Room is an impressive Executive Boardroom complete with smart wooden tables and leather armchairs. This suite can comfortably seat up to 22 delegates and offers natural daylight, air conditioning and a 65" LCD with a built in Apple TV, accessible through analogue and wireless connections.

Blue Room

The Blue Room is an Executive Boardroom seating up to 14 delegates. This suite offers stylish wooden tables and leather armchairs for maximum comfort as well as natural daylight, air conditioning and a 47" LCD with built in Apple TV, accessible through analogue and wireless connections.

Arden Suite

The Arden Suite is a stylish 'Turret-Cornered' suite catering for up to 175 delegates. Inclusive of 3 Phase Power, natural daylight, air conditioning, it also offers a 3m ceiling mounted Electric Projection Screen and LCD Projector. The Arden Suite comes combined with an outdoor terraced area overlooking the lake, an ideal space for a breath of fresh air on busy days.

Green Room

The Green Room is a small Executive Boardroom seating up to 8 delegates and offering natural daylight, air conditioning and a 47" LCD with built in Apple TV, accessible through analogue and wireless connections.



DINING OPTIONS



Brasserie Restaurant



The Lodge

The Brasserie is at the heart of Ardencote, overlooking the glorious Warwickshire Countryside and is the latest addition to Ardencote's drinking and dining experience.

The 1 Rosette Brasserie has been tastefully designed to complement the existing and ever popular Conservatory Bar; overlooking the manicured lawns and grounds. The Brasserie Terrace has proven to be the perfect setting for alfresco dining during our wonderful Spring, Summer and early Autumn months.

Conferences also have the opportunity for private dining in a number of our rooms, including The Lodge, Palms Conservatory and Oak Room.

Please speak to our events team to find out more about private dining options.

LAKESIDE

FLOOR PLAN & CAPACITIES



Suite	Boardroom	Cabaret	Classroom	Classroom with back projection	Dinner	Dinner Dance	Exhibition	Reception	Theatre	Theatre with back projection	U-Shape
Arden	26	110	50	30	160	150	100	200	175	150	30
Claverdon	36	64	50	30	80	60	100	80	100	60	36
Claverdon 1	24	32	20	N/A	40	N/A	N/A	40	50	N/A	20
Claverdon 2	20	24	16	N/A	24	N/A	N/A	24	40	N/A	18
Cedar Room	22	N/A	N/A	N/A	22	N/A	15	N/A	40	N/A	18
Blue Room	14	N/A	N/A	N/A	N/A	N/A	N/A	N/A	20	N/A	10
Green Room	10	N/A	N/A	N/A	N/A	N/A	N/A	N/A	16	N/A	6

MANOR HOUSE

FLOOR PLAN & CAPACITIES

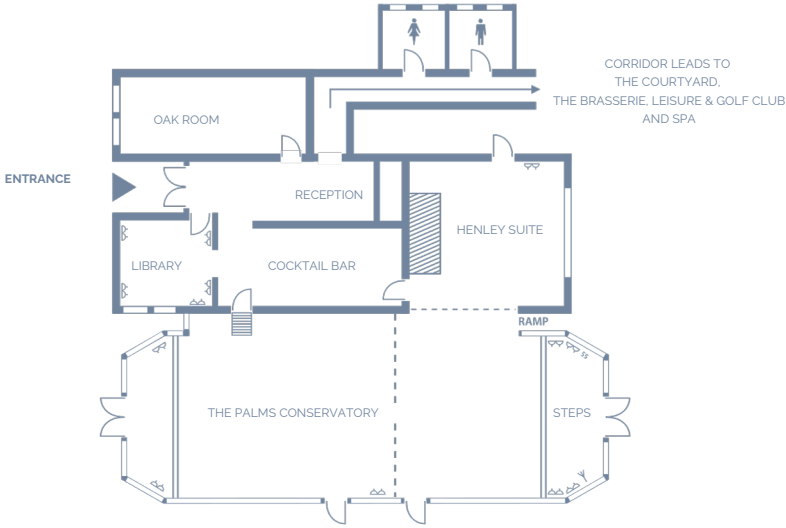

Suite	Boardroom	Cabaret	Classroom	Dinner	Exhibition	Reception	Theatre	U-Shape
Palms Conservatory	N/A	N/A	N/A	120	N/A	N/A	N/A	N/A
Henley Suite	20	32	20	40	30	40	50	20
Oak Room	16	16	N/A	24	N/A	N/A	16	16
Library	10	N/A	N/A	12	N/A	N/A	10	N/A
Teambuilding Area	300							





DELEGATE PACKAGES

Our delegate packages are designed for groups of 8 or more guests. Prices available at time of enquiry.

Day Delegate Package

- Unlimited hot beverages including Tea/Coffee, Cappuccinos, Lattes etc.
- Snacks served between 8am and 5pm
- Main meeting room hire
- Two Course Hot & Cold Buffet Lunch
- Delegate paper and pens
- Still/Sparkling Mineral Water and Sweets
- Flipchart with Pens
- LCD TV with built-in Apple TV or a Screen and LCD Data Projector
- FREE Wi-Fi Internet access
- Free Parking

24 Hour Delegate Package

All items included within our Day Delegate Package plus:

- Three Course Dinner
- Overnight Accommodation
- Full English Breakfast
- Use of the Leisure Facilities from check-in until check-out

LAKESIDE

EXCLUSIVE HIRE

(Price on Request)

For large events where exclusivity is crucial to business, Ardencote offers its Lakeside Wing.

The Facilities Included are:

- 60 Four Star Bedrooms
- 5/6 Meeting Rooms
- 2 Conference Café Stations
- The Lodge Restaurant for Lunch/Dinner
Private Dining (*if required*)

Meeting Rooms Include:

- Arden Suite seating up to 175 delegates
- Claverdon Suite seating up to 100 delegates (ability to be partitioned into two separate suites)
- Cedar Suite seating up to 40 delegates
- Blue Room seating up to 20 delegates
- Green Room seating up to 16 delegates

The Package:

- Unlimited Refreshments & Snacks
- Meeting Room Hire
- Notepads & Pens
- Still/Sparkling Water & Sweets
- Flipcharts & Pens
- The Latest Audio Visual Equipment
- 2 Course Hot & Cold Buffet Lunch
- Three Course Dinner
- Overnight Accommodation
- Full English Breakfast
- Full use of Leisure Facilities

FREE Added Extras:

- All Meeting Rooms offer Natural Daylight and Air-Conditioning
- Superfast Wi-Fi Internet Access
- Air Conditioned Bedrooms
- Free Car Parking



LEISURE CLUB



The Leisure Facilities at Ardencote offer an unrivalled experience that exceeds a business traveller's expectation. With an extensive range of facilities to support every ability of fitness, the leisure club understands that sustaining a healthy lifestyle is integral for overall wellbeing.

All conference residents have full access to the Leisure Club facilities during their stay.

Facilities available:

- Indoor heated Swimming Pool, Jacuzzi, Steam Room and Sauna
- Life Fitness Cardiovascular Gym
- Human Star-Trac Weights Gym
- 3 All Weather Floodlit Tennis Courts
- 3 Glass-backed Squash/Racketball Courts
- Dance Studio and access to classes
- Golf Simulator*

*Additional charges apply.

DESTINATION SPA

The award winning Destination Spa is a tranquil haven within Ardencote, dedicated to wellness and relaxation. The destination spa offers state-of-the-art thermal and relaxation facilities, making it an ideal way to unwind after a power packed day in the boardroom.

Facilities available with a Destination Spa booking:

- Aromatherapy Steam Room
- Himalayan Salt Sauna
- Tepidarium
- Outdoor Tyrolean Kilo Sauna
- Outdoor Hot Tub
- Ice Fountain
- Monsoon Experience Shower
- Foot Spa
- Outdoor Heated Swimming Pool (Summer only)
- Plunge Pool (Winter only)
- Relaxation Lounge
- Tranquillity Lounge

The Destination Spa also offers a wide variety of spa treatments.

Access and treatments operate on a booking system and are charged additionally.

For more information
Visit: www.ardencote.com/spa
Call: 01926 843111
Email: spa@ardencote.com

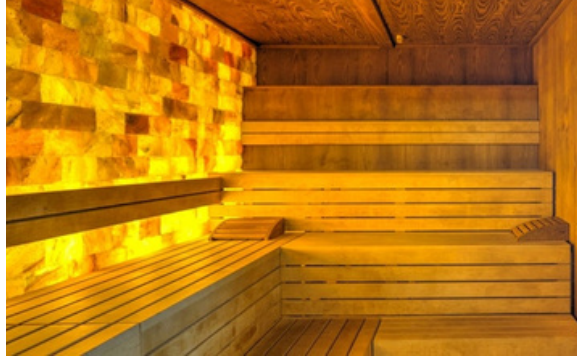

GOLF AT ARDENCOTE

Ardencote boasts of a 5,045 yard PAR 67, 18 hole course designed to USGA standards.

Set in 83 acres of parkland, the new course has been designed to cater for both entry level and experienced golfers. The picturesque layout uses the gentle undulating contours to create a very enjoyable and rewarding course. The manicured fairways & pristine first-cut enables a 4 ball to comfortably complete the course in 3.5 hours, allowing plenty of time to have a drink or meal in our Brasserie afterwards. The course is ideal for your Corporate and Society Golf Day. Our Events Team are here to create a tailor made Golf Day to suit your requirements.



GOLF PACKAGES

Corporate Golf Days can be tailored to meet your individual needs and are ideal for charity events, staff reward days or entertaining clients and suppliers!

Option 1

From £44.50* per person

- Registration area and introduction to facilities with our Golf Team
- Tea & coffee with bacon baps on arrival
- Access to changing facilities & lockers
- Access to practice areas
- 18 holes of golf
- 'Nearest the Pin' and 'Longest Drive' Competitions
- Scoring completed by our Golf Team
- Light Meal on return with coffee

Option 2

From £54.50* per person

- Registration area and introduction to facilities with our Golf Team
- Golf Team to assist with competitions and scoring
- Tea & coffee with bacon baps on arrival
- Access to changing facilities & lockers
- Access to practice areas
- 18 holes of golf
- 'Nearest the Pin' and 'Longest Drive' Competitions
- Private Room for meal and presentations with Private Bar
- 2 Course Meal with coffee

Golf Days can be tailored to meet your individual needs, please contact us for bespoke packages.

**Subject to availability. Minimum numbers apply. Prices quoted above are 'from' prices, an accurate quote will be provided on enquiry.*



TEAMBUILDING



Ardencote offers beautiful outdoor and indoor spaces that lend themselves to interesting team binding and competitive activities. Whether you are looking for archery on the lawn or a Round of Golf on our 18 Hole Course we have something to suit all budgets and for everyone to enjoy. For the evening, we can arrange entertainment, themed events, BBQ's and banquets.

Ardencote Activities

We have a dedicated Team who can assist you with light-hearted challenges such as:

- Fun Golf Challenges with our PGA Professional
- Relaxing Spa Treatments
- Treasure Hunts around our 83 acre estate
- Lawn Games such as giant Jenga and croquet
- Cocktail Tasting
- Sports Day
- Dance and Fitness Classes

Outsourced Activities

Alternatively, we can arrange for one of our partner team building companies to offer something a little more challenging or exciting. We have a 3 acre lake which can be used for teambuilding!

- Archery
- Axe Throwing
- Pistol/Rifle Shooting
- Bumper Balls
- Climbing Wall
- Rafting
- Canoeing
- Kayaking
- Traditional Team Building Games
- Wellness workshops



Ardencote
The Cumsey, Lye Green Road, Claverdon
Warwick CV35 8LT
01926 843111
events@ardencote.com
www.ardencote.com