



Ardencote

CONFERENCE & EVENTS



## WE MEAN BUSINESS

---

Ardencote is a four star Hotel centrally located in the heart of the Midlands, just off the M40 J15 and on the outskirts of both Warwick and Stratford-upon-Avon. Over the years Ardencote has evolved from a family home to an award winning Hotel offering unrivalled conference facilities and excellent customer service. Today, Ardencote boasts 110 bedrooms, 18 meeting rooms, 2 award winning restaurants, 18 hole golf course, leisure club and spa.

*Take pleasure in organising your next event at Ardencote*





## LAKESIDE SUITES

---

- Arden Caberet
- Claverdon Suite
- Cedar Room
- Blue Room
- Green Room
- 8 x Syndicate Rooms



## MANOR HOUSE SUITES

---

- Palms Conservatory
- Henley Suite
- The Oak Room
- The Library

## MEETING YOUR NEEDS

---

Ardencote's 18 meeting rooms are located in both the 19th century Manor House and in the purpose-built conference centre. All meeting rooms have natural daylight and complimentary super fast Wi-Fi internet access.

## THE LODGE

---

- Independent Conference Venue
- Lakeside Venue
- Private Terrace
- Private Bar
- Private Lounge
- Private Car Park





*Meetings & Events at Ardencote*

## MEETING ROOMS

---

### Arden Suite

The Arden Suite is a stylish 'Turret-Cornered' suite catering for up to 175 delegates. It offers scenic views overlooking the lake. Inclusive of 3 Phase Power, natural daylight, air conditioning, 3m ceiling mounted Electric Projection Screen and LCD Projector.

### Claverdon Suite

The Claverdon Suite is an elegant suite suitable for up to 100 delegates with stunning views of the Ardencote's manicured grounds, providing natural daylight, air conditioning and a 65"LCD with built in Apple TV, accessible through analogue and wireless connections. The Claverdon divides into 2 rooms, via a fully partitioned sound proofed wall.

Claverdon I is suitable for 50 delegates, providing natural daylight, air conditioning and a 65"LCD with built in Apple TV, accessible through analogue and wireless connections.

Claverdon II is suitable for 40 delegates, providing natural daylight and air conditioning.

### The Palms Conservatory

The Palms Conservatory boasts its own private outdoor seating area, ideal for drinks receptions. A stylish conservatory seating up to 120 guests for a banquet, complete with its own private bar, dance floor and staging area. In conjunction with the Henley Suite the Palms Conservatory can comfortably accommodate 160 guests.

### Cedar Room

The Cedar Room is an executive boardroom complete with smart wooden tables and leather armchairs. This suite can comfortably seat up to 22 delegates and offers natural daylight, air conditioning and a 65"LCD with built in Apple TV, accessible through analogue and wireless connections.

### Oak Room

The Oak Room bursting with natural daylight, is a beautiful suite with high ceilings, oak panelling, ornate chandeliers and a working fireplace, situated within the 19th century Manor House, the Oak Room can be used for both meetings and private dining.

### Blue Room

The Blue Room is an executive boardroom seating up to 14 delegates. This suite offers stylish wooden tables and leather armchairs for maximum comfort as well as natural daylight, air conditioning and a 47"LCD with built in Apple TV, accessible through analogue and wireless connections.

### Green Room

The Green Room is a small executive boardroom seating up to 8 delegates and offering lots of natural daylight, air conditioning and a 47"LCD with built in Apple TV, accessible through analogue and wireless connections.

### Syndicate Rooms

The Syndicate Rooms are located on the ground floor of the Conference Centre easily accessible to all the meeting rooms and make an ideal addition to any of our conference centre suites. These rooms seat between 8-10 delegates and offer natural daylight and air conditioning. AV can be arranged for these suites if required.

### Henley Suite

The Henley Suite situated in the heart of the Manor House is an elegant suite for up to 50 delegates. Filled with natural daylight with blackout facility, air conditioning and a 65"LCD with built in Apple TV, accessible through analogue and wireless connections.

### Library

The Library is an elegantly furnished suite with original features, the ideal venue for small meetings and intimate private dining.

### Lodge

The Lodge is situated on the water's edge of the 3 acre lake overlooking the stunning grounds of Ardencote and the Warwickshire countryside. This suite is ideal for exclusive conference hire or corporate functions looking for a setting to host private lunches, dinners, events or even a BBQ on The Lodge Terrace.

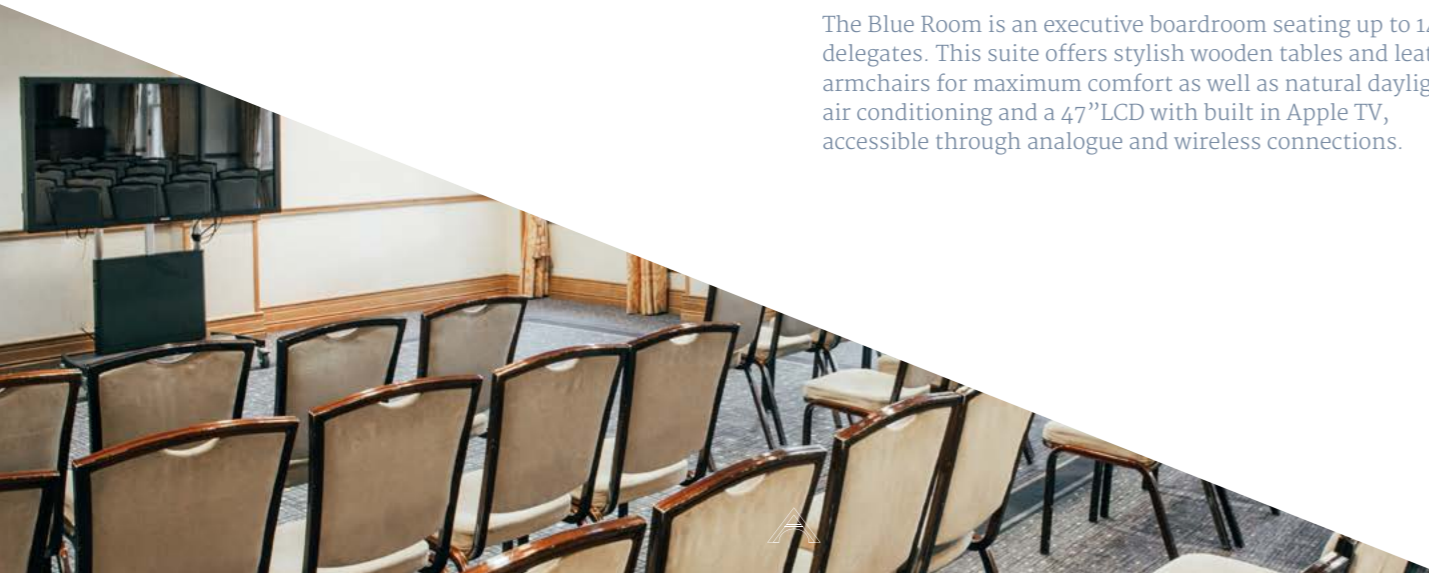

# CONFERENCE FLOOR PLAN

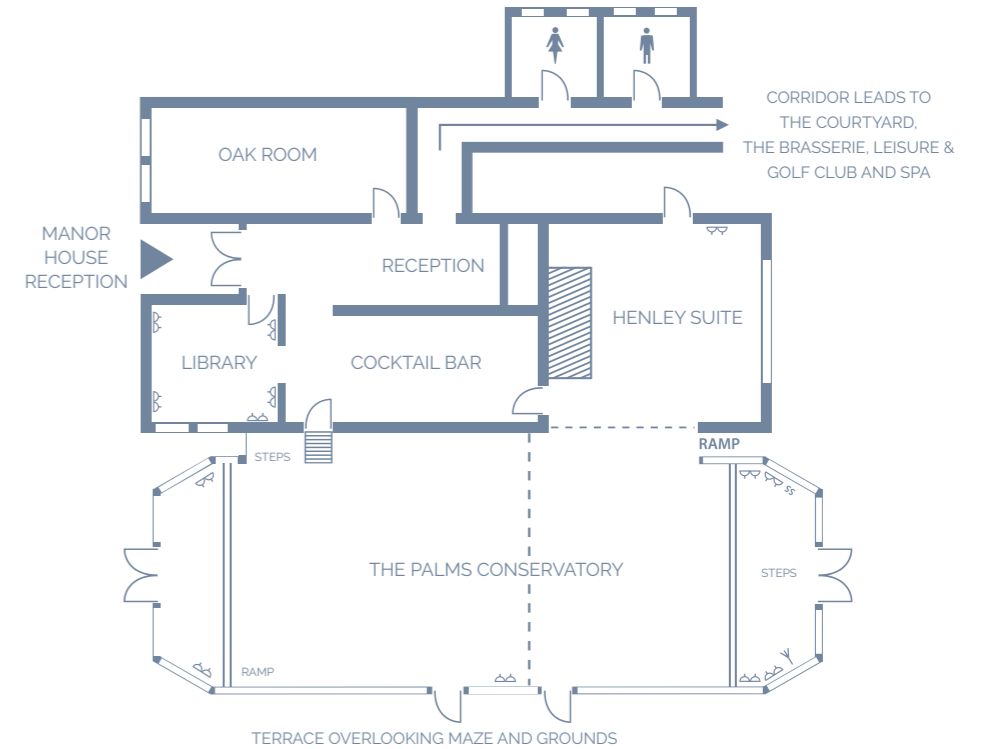

	Room Size	Min Ceiling Height	SqM2	Boardroom	Cabaret	U Shape	Theatre Style	Classroom	Dinner	Dinner Dance
Arden Suite	15.1m x 12m	3.0	181	50	110	40	175 F/P 150 B/P	70 F/P 55 B/P	150	120
Claverdon Suite	14.4m X 8.1m	2.7	123	36	60 F/P 50 B/P	30	100 F/P 80 B/P	50 F/P 30 B/P	60	60
Claverdon I	7.3m x 8.1m	2.7	61	24	32	20	50	20	N/A	N/A
Claverdon II	7.1m x 8.1m	2.7	57	20	24	16	40	20	N/A	N/A
Cedar Room	5.4m x 8.1m	2.5	44	22	N/A	18	40	N/A	25	N/A
Blue Room	5.7m x 3.9m	2.5	22	14	N/A	10	20	N/A	N/A	N/A
Green Room	4.2m x 4.1m	2.5	17	10	N/A	6	16	N/A	N/A	N/A
Palms Conservatory	25.2m x 9.8m	4.0	247	N/A	N/A	N/A	N/A	N/A	160	120
Henley Suite	7.8m x 7.3m	4.0	57	25	32	22	50	24	40	N/A
Library	5.4m x 5m	4.0	27	12	N/A	8	20	N/A	12	N/A
Oak Room	8.3m x 5.9m	4.0	49	16	N/A	N/A	30	N/A	16	N/A
Syndicate x 8 rooms	3.9m x 3.2m	2.5	11	8	N/A	6	12	N/A	N/A	N/A
The Lodge	18.4m x 8.4m	2.4	155	16	32	18	50	N/A	84	64





## DELEGATE PACKAGES

Our delegate packages are designed for groups of 8 or more guests and are prices negotiated at time of enquiry. For groups less than this number, room hire and individual food and beverage charges will be applied.

### Day Delegate Package

- Unlimited hot beverages including Tea/Coffee, Cappuccinos, Lattes etc. Fresh Fruit and Snacks served between 8am and 5pm
- Main meeting room hire
- Two Course Hot & Cold Buffet Lunch
- Delegate paper and pens
- Still/Sparkling Mineral Water and Sweets
- Flipchart with Pens
- LCD TV with built-in Apple TV or a Screen and LCD Data Projector
- FREE Wi-Fi Internet access
- Free Parking

### 24 Hour Delegate Package

All items included within our Day Delegate Package plus:

- Three Course Dinner
- Overnight Accommodation
- FREE Upgrade to a suite for the organiser\*
- Full English Breakfast
- Use of the Leisure Facilities from check-in until check-out

\*Suite upgrade is based on events for 50+ Residential Delegates and is subject to availability.

## LAKESIDE EXCLUSIVE HIRE

### The Facilities Included are:

- 60 Four Star Bedrooms
- 5/6 Meeting Rooms
- 8 Syndicate Rooms
- 2 Conference Café Stations
- The Lodge Restaurant for Lunch/Dinner Private Dining (if required)

### The Package

- Unlimited Refreshments & Snacks
- Meeting Room Hire
- Notepads & Pens
- Still/Sparkling Water & Sweets
- Flipcharts & Pens
- The Latest Audio Visual Equipment
- 2 Course Hot & Cold Buffet Lunch
- Three Course Dinner
- Overnight Accommodation
- Full English Breakfast
- Full use of Leisure Facilities

### Meeting Rooms Include

- Arden Suite seating up to 175 delegates
- Claverdon Suite seating up to 100 delegates (or can be partitioned into two suites)
- Cedar Suite seating up to 20 delegates
- Blue Room seating up to 14 delegates
- Green Room seating up to 10 delegates
- Option of an additional 8 Syndicate Rooms seating up to 8 delegates in each

### FREE Added Extras

- All Meeting Rooms offer Natural Daylight and Air-Conditioning
- Superfast Wi-Fi Internet Access
- Air Conditioned Bedrooms
- Free Car Parking

£12,500.00 per day



## PRIVATE DINING

---

Ardencote offers a range of Suites for all of your corporate event needs. We have 7 unique and beautifully appointed function suites, all with air conditioning and natural daylight overlooking the stunning Warwickshire countryside and grounds, which is ideal for private dining, lunches, or BBQ's.

### The Packages

We understand that your event is individual, so to ensure that we cater for your requirements your own event coordinator will be on hand to assist in your planning and help you choose what is right for you and your event. Each client will be given a bespoke quotation upon enquiry.

### The Menus

We have a range of sample menus for you to see including, Lunch, Dinner, BBQ and Wine Menus.

### The Suites

- The Palms Conservatory situated in the 19th century Manor House overlooking the manicured rose and Knot gardens.
- Henley Suite also within the Manor House, the Henley Suite sits adjacent to the Palms Conservatory and the intimate Cocktail Bar.
- Oak Room is a beautiful suite situated within the 19th Century Manor House.
- Arden Suite has a more modern decor and is situated on the 3 acre lake with its own private lakeside terrace and stunning turret feature.
- The Outdoor Pavilion is situated within the 3 acre lake on the beautifully manicured island. This outdoor venue is ideal for drinks receptions, BBQ's and events if you really want to impress your guests!
- Claverdon Suite is at the heart of the Lakeside Building and boasts a private terrace overlooking the Ardencote gardens.
- Cedar Room is suited to small groups looking for a more intimate setting, the Cedar Room is modern in decor but with an elegant and traditional tone and offers perfect views over the stunning gardens.
- The Lodge is located on the water's edge of the 3 acre lake overlooking the manicured grounds and Outdoor Pavilion. The Lodge offering a truly unique setting and informal dining venue with bar, lounge and terrace.

## RESTAURANTS

---

Ardencote has two award winning restaurants to offer your delegates; The Brasserie, and The Lodge.

The Brasserie is at the heart of Ardencote, overlooking the glorious Warwickshire Countryside and is the latest addition to Ardencote's drinking and dining experience. The 1 Rosette Brasserie has been tastefully designed to complement the existing and ever-popular Conservatory Bar; overlooking the immaculate, manicured lawns and grounds. The Brasserie Terrace has proven to be the perfect setting for alfresco dining during our wonderful Summer and early Autumn.

The Lodge, a 2 Rosette dining experience provides diners with a friendly, informal ambience, which will leave a lasting impression and the Bar and Lounge areas are furnished in a modern and contemporary fashion. On Summer evenings, diners can enjoy their award winning meals served al-fresco, whilst they look out over the beautiful lake and surrounding countryside.







*Experience Ardencote*

## SPA

---

Ardencote Spa is based on a Courtyard design surrounding the opulent Outdoor Heated Swimming Pool. The extensive Spa and Leisure facilities are central to Ardencote's philosophy of exercise and relaxation, combining to produce a feeling of health and vitality. The landscaped grounds have been specifically designed to enhance this ambience, with manicured beds of Lavender at the heart of the design.

For more information...

Visit: [www.ardencote.com/spa](http://www.ardencote.com/spa)

Call: 01926 842000

Email: [spa@ardencote.com](mailto:spa@ardencote.com)



## LEISURE CLUB

---

The facilities that Ardencote offers are unrivalled and suit every healthy lifestyle conference residents have full access to the Leisure Club facilities during their stay.

- Indoor heated Swimming Pool, Jacuzzi, Steam Room and Sauna
- Outdoor heated Swimming Pool (*seasonal opening*)
- Outdoor Hot Tub
- Life Fitness Cardiovascular Gym
- Human Star-Trac Weights Gym
- 3 All Weather Floodlit Tennis Courts
- 3 Glass-backed Squash/Racketball Courts
- Dance Studio



Absorption System

## 18 HOLE GOLF COURSE

---

Set in 83 acres of parkland, the new course has been designed to cater for both entry level and experienced golfers. The picturesque layout uses the gentle undulating contours to create a very enjoyable and rewarding course. The 5,045 yard PAR 67, 18 hole course has been designed to USGA standards, the manicured fairways and pristine first-cut, rough enabling a 4 ball to comfortably complete the course in 3.5 hours, allowing plenty of time to have a drink or meal in our Brasserie afterwards. The course is ideal for your Corporate and Society Golf Days and our Events Team will create a tailor made Golf Day to suit your requirements.



## GOLF PACKAGES

---

Escape for a day to the manicured lawns and fantastic views of our 18 hole golf course. Our Events Team are on hand to arrange a tailor made Golf Day to suit your requirements. Here is a taster of what we can offer.

- Tea/coffee and bacon rolls for your guests on arrival
- Play 18 holes of golf on our challenging course
- Enjoy either a Two Course Lunch or Dinner in the Restaurant
- Opportunity for 'Nearest the Pin' and 'Longest Drive' Competitions
- Ardencote is able to accommodate up to 72 Golfers on a Shotgun starter or 4 Ball tee off every 10 minutes

\*Subject to availability. Minimum numbers apply.



## TEAMBUILDING

---

Whether you are looking for archery on the lawn or a Round of Golf on our 18 Hole Course we have something to suit all budgets and for everyone to enjoy. For the evening, we can arrange entertainment, themed events, BBQ's and banquets.

### Ardencote Activities

We have a dedicated Team who can assist you with light-hearted challenges such as:

- Fun Golf Tournaments/Challenges with our PGA Professional
- Relaxing Spa Treatments suitable for all needs and budgets
- Treasure Hunts around our 83 acre estate
- Lawn Games and challenges such as giant jenga and croquet
- Cocktail Tasting
- Sports Day
- Lawn Games and challenges such as giant jenga and croquet
- Dance and Fitness Classes

### Outsourced Activities

Alternatively, we can arrange for one of our partner team building companies to offer something a little more challenging or exciting. We have a 3 acre lake which can be used for teambuilding!

- Archery
- Axe Throwing
- Pistol/Rifle Shooting
- Bumper Balls
- Climbing Wall
- Rafting
- Canoeing
- Kayaking
- Traditional Team Building Games



## THE HISTORY

---

Ardencote was originally built in 1863, as the dowry house for Mary the daughter of Thomas Phillips, a wool manufacturer from Manchester. After the 1st World War, the Phillips family sold Ardencote to Mr. James Booth. Under Mr. Booth's ownership, Ardencote flourished. James Booth died in 1937 and his family decided to sell the property to Mr. Tom Brown, an Irish financier who farmed the land until his death in 1980.

Fast forward to now, Ardencote is owned and managed by Mr. Huckerby- a truly independent, family-run hotel, thriving against all the odds in an environment increasingly dominated by homogenous hotel chains. Mr. Huckerby has added financial stability and entrepreneurial expertise to the hotel, which now proudly boasts 110 four star bedrooms, 18 conference and banqueting suites and two award winning, rosetted restaurants. The leisure facilities have been recently updated to include indoor and outdoor swimming pools, squash courts, floodlit tennis courts, cardiovascular and free weights gym and a dance studio, as well as an 18 hole golf course.



Ardencote, The Cumsey, Lye Green Road, Claverdon, Warwick, CV35 8LT  
01926 843111 [corporate@ardencote.com](mailto:corporate@ardencote.com)

[www.ardencote.com](http://www.ardencote.com)